

Less Stress. More Reliable Connections.

Agilent InfinityLab Quick Connect Fittings

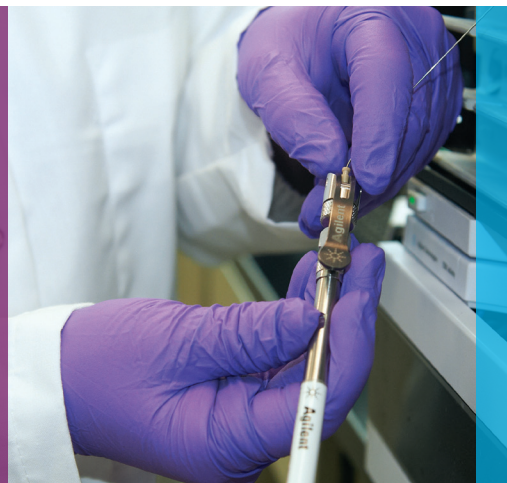

Perfect column connections for UHPLC and HPLC systems

Poorly connected fittings are one of the top reasons for broad or tailing peaks, loss of resolution, and overall poor chromatography. Now, with Agilent InfinityLab Quick Connect fittings, you can be sure you're getting a perfect column connection, every time.

- **Truly finger-tight connection:** no special training is needed, so differences in user style will not affect your chromatography
- **Spring-loaded design:** now you can make zero dead volume connections with LC columns—as easy as pressing a lever
- **Reliable and reusable:** InfinityLab Quick Connect fittings are long lasting, reseal tightly, and are stable up to 1300 bar (18,850 psi) even after 200+ reconnections
- **Fast, easy connections:** save time and trouble, now also for standard HPLC with 0.17 mm id and 0.25 mm id capillaries.

Agilent InfinityLab Quick Connect fittings deliver superior chromatographic performance.

Agilent InfinityLab Quick Connect fittings belong to the InfinityLab family—an optimized portfolio of LC instruments, columns, and supplies, designed to work in perfect harmony. Combined with Agilent OpenLAB software and Agilent CrossLab Services, Agilent InfinityLab provides you with end-to-end support to make every day more productive.

Learn more at: www.agilent.com/chem/infinitylab

3 simple steps ...1 perfect connection

Step 1

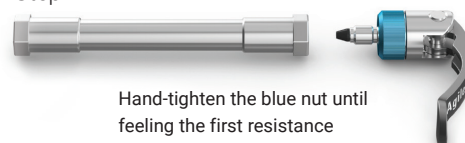

Hand-tighten the blue nut until feeling the first resistance

Step 2



Depress the lever, 1300 bar tight

Step 3



The proprietary Agilent design features a spring-loaded mechanism for zero dead volume and a sure, tight connection.



Significantly reduce your costs with InfinityLab Quick Connect fittings

- Up to 200 uses versus only 3 uses for traditional fittings
- No training needed
- Less time connecting fittings
- Fewer damaged columns
- Reliable chromatographic performance

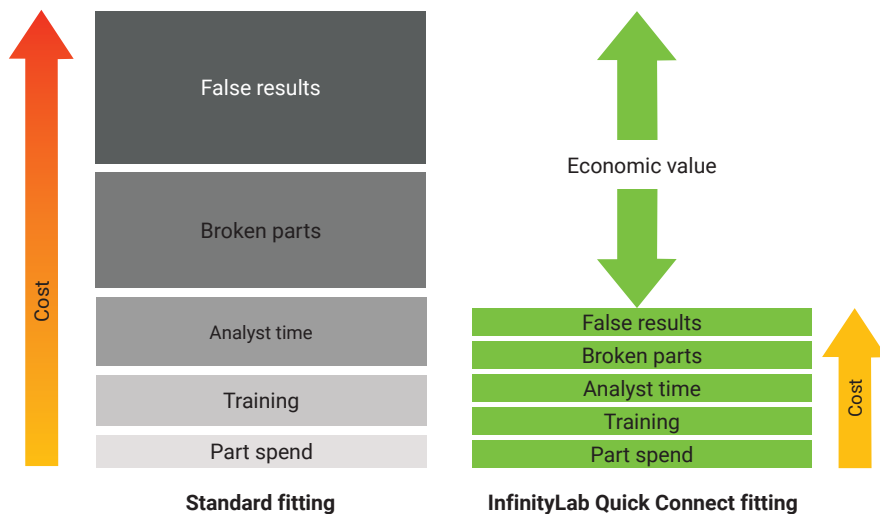

In a tight spot? Try an InfinityLab Quick Turn fitting

For instrument connections with insufficient space for InfinityLab Quick Connect fittings, you can rely on Agilent InfinityLab Quick Turn fittings. Like our Quick Connect fittings, they leverage a proprietary spring-loaded design for zero dead volume and a sure connection.



Note: These fittings can only be used with capillaries using a long socket. See the ordering information for a list of available capillaries.

Agilent InfinityLab Quick Connect Fittings—Awards for Innovation

Agilent Quick Connect fittings shortlisted for the prestigious R&D 100s awards 2015. For more than 50 years, the editors of R&D magazine have chosen the 100 "most technologically significant products introduced into the marketplace over the past year". Once again, an Agilent product is in line for this mark of excellence.



Agilent InfinityLab Quick Connect fittings win TASIA Innovation award 2014. InfinityLab Quick Connect fittings won The Analytical Scientist Innovation Award 2014 because it's the only true finger-tight UHPLC fitting stable to 1300 bar that can be used over and over again without loss of performance.



Recommended Quick Connect and Quick Turn fittings for Agilent InfinityLab LC Series instruments

Agilent LC model	Column Inlet		Column Outlet	
	Description	Part number	Description	Part number
1290 Infinity LC Series	Quick Connect assembly 0.12 x 105 mm*	5067-5957	Quick Turn fitting	5067-5966
1260 Infinity LC Series	Quick Connect assembly 0.17 x 105 mm*	5067-6166	Quick Turn capillary 0.12 x 280 mm	5-1191

*Includes 1 Quick Connect fitting, 1 capillary, 1 Swagelok fitting.

Specifications and ordering information

The InfinityLab Quick Connect and Quick Turn fittings are available in different lengths and internal diameters, including 0.075 mm id, 0.12 mm id, 0.17 mm id and 0.25 mm id to fit most UHPLC as well as HPLC applications. The 0.25 mm id capillaries with a female connection are optimized for Waters Alliance systems.

InfinityLab Quick Connect Fitting Description	Part number	InfinityLab Quick Connect Fitting Description	Part number
Assemblies		Stainless Steel 0.17 x 150 mm M4	
Stainless steel 0.075 x 105 mm	5067-5961	Stainless Steel 0.12 x 150 mm M4	5500-1289
Stainless steel 0.075 x 150 mm	5067-6163	Stainless Steel 0.12 x 340 mm M4	5500-1416
Stainless steel 0.075 x 220 mm	5067-6164	PEEK/Stainless steel, bio-inert, 0.17 x 280 mm	5500-1276
Stainless steel 0.075 x 280 mm	5067-6165	PEEK/Stainless steel, bio-inert, 0.17 x 500 mm	5500-1277
Stainless steel 0.12 x 105 mm	5067-5957	InfinityLab Quick Turn Fitting Description	
Stainless steel 0.12 x 150 mm	5067-5958	Part number	
Stainless steel 0.12 x 220 mm	5067-5959	Fittings and ferrules	
Stainless steel 0.12 x 280 mm	5067-5960	Quick Turn fitting	5067-5966
Stainless steel 0.17 x 105 mm	5067-6166	Front ferrule	5043-0924
Stainless steel 0.17 x 150 mm	5067-6167	Capillaries	
Stainless steel 0.17 x 220 mm	5067-6168	Stainless steel 0.075 x 105 mm long socket	5500-1198
Stainless steel 0.17 x 280 mm	5067-6169	Stainless steel 0.075 x 150 mm long socket	5500-1232
Fittings and ferrules		Stainless Steel 0.075 x 250 mm long socket	5500-1206
Quick Connect fitting	5067-5965	Stainless steel 0.075 x 500 mm long socket	5500-1205
Front ferrule	5043-0924	Stainless steel 0.12 x 105 mm long socket	5500-1188
Capillaries		Stainless steel 0.12 x 150 mm long socket	5500-1189
Stainless steel 0.075 x 105 mm	5500-1174	Stainless steel 0.12 x 180 mm long socket	5500-1233
Stainless steel 0.075 x 150 mm	5500-1175	Stainless steel 0.12 x 200 mm long socket	5500-1190
Stainless steel 0.075 x 220 mm	5500-1176	Stainless steel 0.12 x 280 mm long socket	5500-1191
Stainless steel 0.075 x 250 mm	5500-1177	Stainless steel 0.12 x 500 mm long socket	5500-1192
Stainless steel 0.075 x 280 mm	5500-1178	Stainless steel 0.17 x 105 mm long socket	5500-1193
Stainless steel 0.12 x 105 mm	5500-1173	Stainless steel 0.17 x 150 mm long socket	5500-1194
Stainless steel 0.12 x 120 mm	5500-1247	Stainless steel 0.17 x 180 mm long socket	5500-1234
Stainless steel 0.12 x 150 mm	5500-1172	Stainless steel 0.17 x 200 mm long socket	5500-1195
Stainless steel 0.12 x 220 mm	5500-1171	Stainless steel 0.17 x 280 mm long socket	5500-1196
Stainless steel 0.12 x 280 mm	5500-1170	Stainless steel 0.17 x 380 mm long socket	5500-1235
Stainless steel 0.12 x 400 mm	5500-1179	Stainless steel 0.17 x 400 mm long socket	5500-1236
Stainless steel 0.12 x 500 mm	5500-1180	Stainless steel 0.17 x 500 mm long socket	5500-1197
Stainless steel 0.17 x 105 mm	5500-1181	Stainless steel 0.17 x 700 mm long socket	5500-1237
Stainless steel 0.17 x 120 mm	5500-1248	Stainless steel 0.25 x 105 mm long socket with a female connection	5500-1261
Stainless steel 0.17 x 150 mm	5500-1182	Stainless steel 0.25 x 150 mm long socket	5500-1262
Stainless steel 0.17 x 220 mm	5500-1183	Stainless steel 0.25 x 400 mm long socket	5500-1263
Stainless steel 0.17 x 280 mm	5500-1230	Stainless steel 0.12 x 130 mm long socket M4	5500-1200
Stainless steel 0.17 x 500 mm	5500-1231	Stainless steel 0.12 x 150 mm long socket M4	5500-1288
Stainless steel 0.25 mm x 105 mm with a female connection	5500-1258	Stainless steel 0.17 x 150 mm long socket M4	5500-1290
Stainless steel 0.25 mm x 150 mm	5500-1259	Note: InfinityLab Quick Turn fittings require the capillaries specified in this table.	
Stainless steel 0.25 mm x 400 mm	5500-1260		

Note: The InfinityLab Quick Connect fitting can only be equipped with an InfinityLab capillary specified in this table. The InfinityLab capillary is designed with a spring and a holder.

Maximize efficiency for your liquid chromatography workflows

Learn more about how to improve the efficiency of your LC workflow with the following products:

- InfinityLab Poroshell 120 columns
- InfinityLab Quick Connect and Quick Turn fittings
- InfinityLab solvent bottles
- Smart InfinityLab supplies
- InfinityLab Kits
- InfinityLab Flex Bench Family

Request your InfinityLab LC supplies catalog—an easy-reference putting commonly used LC supplies at your fingertips. More information at:

www.agilent.com/chem/infinitylab-supplies-catalog



Learn more at: www.agilent.com/chem/quickconnect

For Research Use Only. Not for use in diagnostic procedures.

This information is subject to change without notice.

© Agilent Technologies, Inc. 2015, 2017, 2018
Published in the USA, July 1, 2018
5991-5164EN